

HATFIELD, ANNE P	040-001
COFFINS NECK ROAD	040-001-001
WEBB, ALICE N	040-002
BEAULIEU, ERNEST &	040-003
DNB HOLDINGS, LLC	040-004
SADICK, FREDERICK M JR	040-005
SMITH, PAUL R - TRUSTEE	040-006
GOLET, FRANCIS & SUSAN	040-007
PIVIROTTO, ARTHUR M, III	040-008
MELTZ, LUCILLE C	040-009
MARIE, PAULA	040-010
JACKSON, KATHLEEN	040-011
BOWDEN, WILLIAM K	040-012
JURCHISON STACEY	040-013
PORTALUPI, JOANN	040-014
REEVES, DEBBIE	040-015
GIBSON, TRENT A.	040-016
REEVES DEBBIE	040-017
CASTELLANE, RICHARD	040-018
BIGWOOD, JAMES - TRUSTEE	040-019
HARRIS, JOSEPH J JR	040-021
BIGWOOD, JAMES B -	040-023
BLEVIO, HENRY L	040-024
HARRINGTON, JOHN P	040-025
HARRINGTON, MARY ELLEN	040-026
MACKENZIE, RONALD G	040-027
MOLVAR, JOHN W	040-028
PINTON, ROBERT B	040-029
DEAN, ROBERT L	040-030
HAYES, CHARLES T TRUSTEE	040-031
HAYES, CHARLES T	040-032
STIRLING, JOHN AND TERESA	040-033
VIGNOS, PAUL CO TRUSTEE	040-035
REID, ALA H	040-036
REID, ALA H	040-037
LELIEVRE, HELEN J	040-038
WHEELHOUSE LLC.	040-039
GEAGHAN, BERNARD O	040-041
WOLCOTT, SHERWOOD G &	040-042
BAKER, HUGH M JR	040-043
MILLER, MICHAEL	040-044
TOPPAN, WELLINGTON C JR	040-045
STEPHENSON, ISAAC	040-046
WARFIELD, MARGE	040-047
CARLISTA, THOMAS	040-048
CUMMINGS, COREY	040-049
GUNTHER, ERIC	040-050
HUGHES, SIDNEY L	040-052
JAEDICKE, RICHARD J	040-053
FEATHERINGHAM, GARY L	040-054
HOLMES, WILLIAM R & DEBRA	040-055
SHUMAN, ROBERT D.	040-056
LYNSKEY, JOHN J	040-058
LYNSKEY, JOHN J	040-059
COMOLLI, THOMAS E	040-060
ZIBURA, PAUL F	040-061
MCCARTHY, JOHN F. JR	040-062
DEAN, ROBERT L	040-063
GILMARTIN, MARY	040-064
COUGHLIN, DOUGLAS E	040-065
COBSCOOK SHORES INC.	040-067
COBSCOOK SHORES, INC	040-069
COBSCOOK SHORES INC	040-070
COBSCOOK SHORES, INC.	040-071
DOWNEAST COASTAL	040-073
COBSCOOK SHORES, INC	040-074
HAMILTON, WINTER	040-074-001
HAMILTON, DAVID E & JOYCE	040-074-002
TURNER, JOEL J	040-074-003
ZUSCHLAG, WALTER J	040-075
EATON, JASON C	040-076
TIRRELL, ERIC	040-076-001
FRIEDMAN, HADLEY J.	040-077
TREAT, SARA L	040-078
GARCEAU, KENNETH J	040-079
RATH, JOSEPH C	040-080
HARMAN, DENNIS J	040-081
TRODELLA, VICTOR	040-082
YOUNG, MICHAEL C	040-083
DANE, NATHANIEL B	040-084
HAGAR, G HENRY	040-085
SAYERS, GARY J & PAMELA C	040-086
REIFSTECK, DANIEL M	040-087
MCANDREW, JOHN P	040-087-001
CANIZZARO, ANTHONY JR	040-088
ALDEN, DAWN C TRUSTEE	040-089
DAVIS, JOHN A	040-090
PERKINS, JOAN	040-091

LEGEND
PARCEL NUMBERS.....1
ADJACENT MAPS.....2
MATCH LINE.....

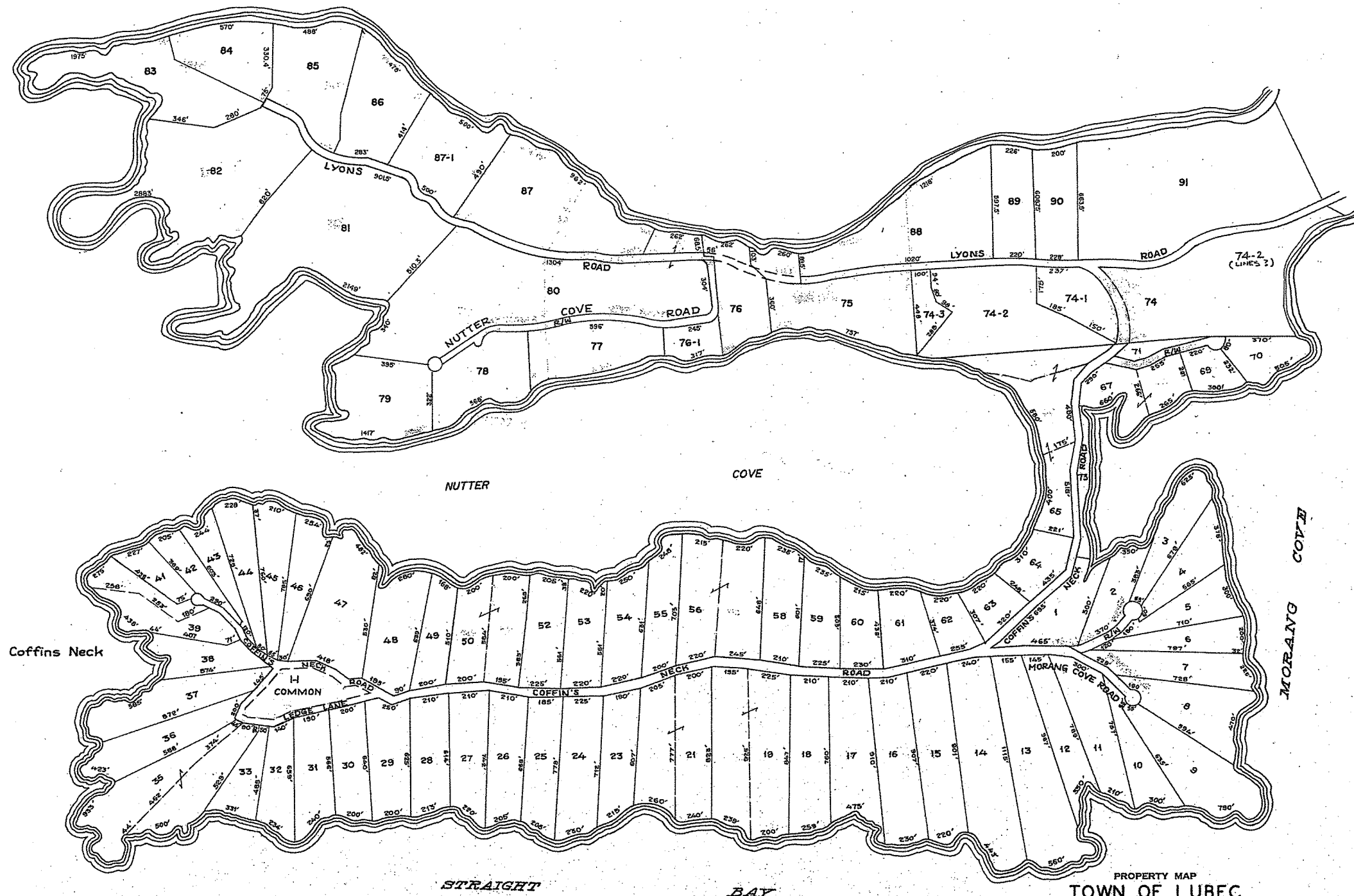

PROPERTY MAP
TOWN OF LUBEC
WASHINGTON COUNTY, MAINE

JAMES W. SEWALL COMPANY
SCALE 1 INCH = 300 ± FEET
OLD TOWN, MAINE